



 paulwallace

Roundhills, Waltham Abbey, EN9 1UQ |
Offers in Excess of £260,000 | Leasehold

Roundhills, Waltham Abbey, EN9 1UQ

Offering an excellent opportunity for modernisation, this first-floor two-bedroom maisonette with private entrance, a fitted kitchen and bathroom, two generously sized double bedrooms, features gas central heating, double glazed windows, garage, and boasts an impressive 940 years remaining on the lease with no service charges.

Key features

- Two-bedroom first-floor maisonette
- Well-fitted kitchen and bathroom
- Gas central heating and double glazed windows
- Exceptional lease length: 940 years remaining
- Private entrance / own front door
- Two spacious double bedrooms
- Includes a garage
- No service charges

Property Information

Tenure

Leasehold

Council Tax

C

EPC Rating

Local Authority

Epping Forest District Council

Lease Length

Service Charge & Ground Rent

TBC



 paulwallace
estate agents

hoddesdon@paulwallace.co.uk

01992 466471



 paulwallace



GROUND FLOOR
677 sq.ft. (62.9 sq.m.) approx.

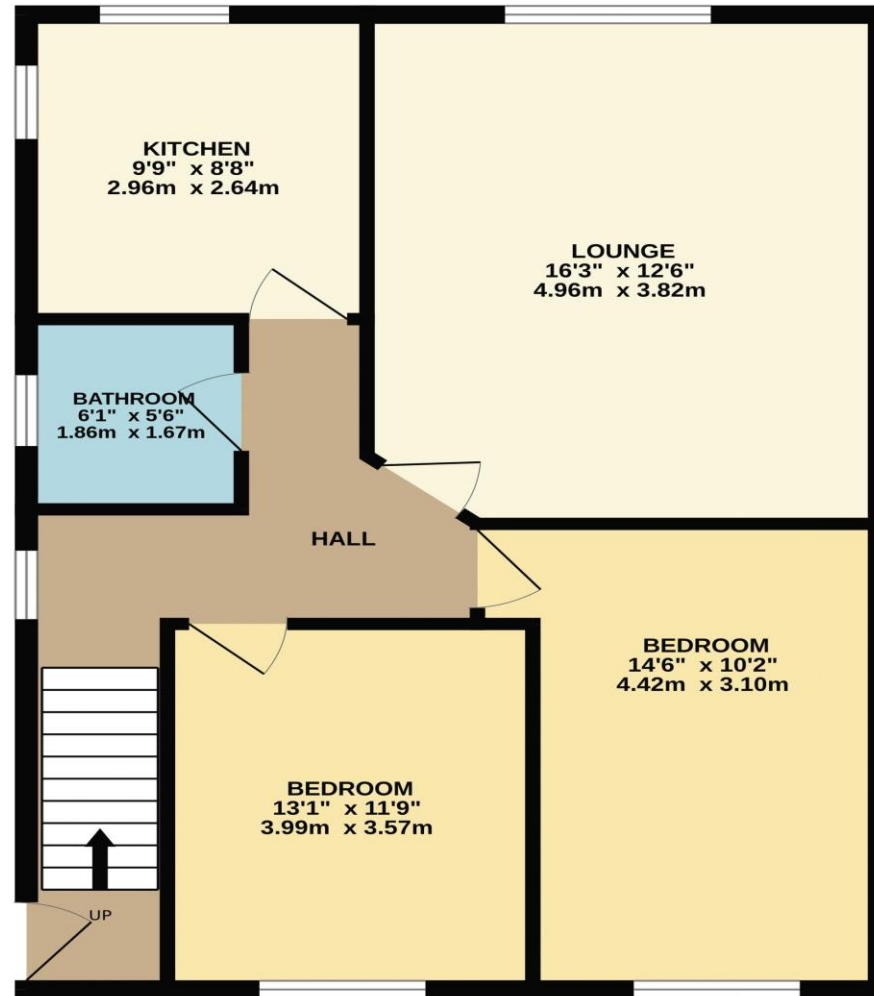

TOTAL FLOOR AREA : 677 sq.ft. (62.9 sq.m.) approx.

Whilst every attempt has been made to ensure the accuracy of the floorplan contained here, measurements of doors, windows, rooms and any other items are approximate and no responsibility is taken for any error, omission or mis-statement. This plan is for illustrative purposes only and should be used as such by any prospective purchaser. The services, systems and appliances shown have not been tested and no guarantee as to their operability or efficiency can be given.
Made with Metropix ©2024



Paul Wallace Estate Agents

70 High Street
Hoddesdon
Hertfordshire
EN11 8ET



01992 466471



hoddesdon@paulwallace.co.uk



www.paulwallace.co.uk



Opening Times

Mon	9am to 6.30pm
Tues	9am to 6.30pm
Wed	9am to 6.30pm
Thurs	9am to 6.30pm
Fri	9am to 6.30pm
Sat	9am to 5.00pm
Sun	Closed



Agents Note: Whilst every care has been taken to prepare these sales particulars, they are for guidance purposes only. All measurements are approximate and are for general guidance purposes only and whilst every care has been taken to ensure their accuracy, they should not be relied upon. Potential buyers are advised to recheck the measurements.